

VEHICLE MOVEMENT KEY

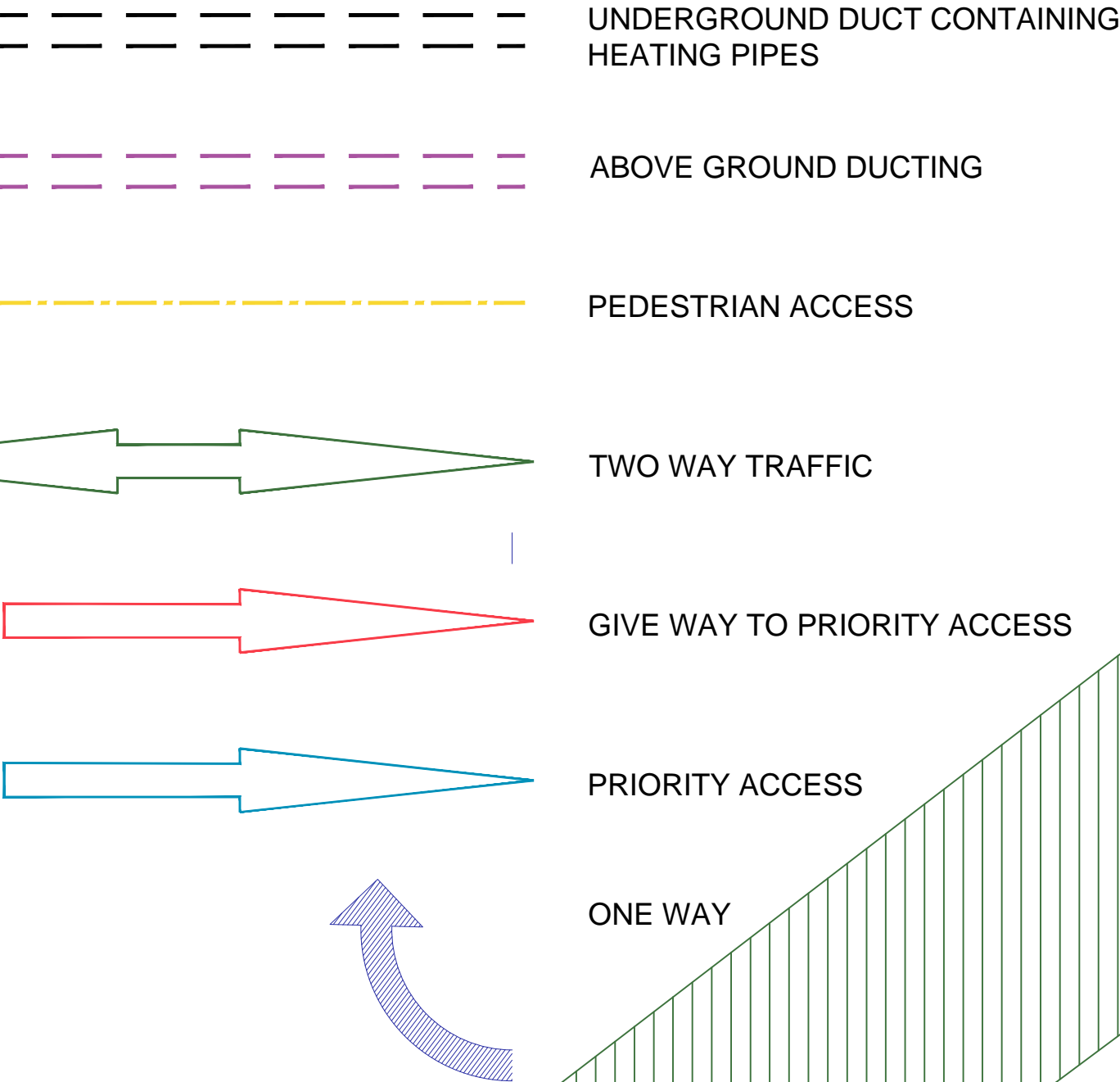

QUANTITIES STORED ON-SITE FOR EXPORT OFF SITE DEPENDANT UPON SPEED AND REGULARITY OF JOURNEYS OFF SITE FOR RECOVERY AND DISPOSAL

AVERAGE 200 TONNES OF MIXED WASTE IMPORTED, COMPRISING

AVERAGE 38 TONNES GENERAL WASTE
AVERAGE 90 TONNES FINES
AVERAGE 30 TONNES INERT WASTE
AVERAGE 20 TONNES WOOD
AVERAGE 4 TONNES SCRAP METAL
AVERAGE 3 TONNES PAPER/CARDBOARD
AVERAGE 15 TONNES HARDCORE

4.75 TONNES PER HOUR FOR 8 HOURS PER DAY OF RESIDUAL WASTE TO S.W.I.P.

THIS DRAWING IS TO SCALE INDICATED FOR PLANNING PURPOSES ONLY. NO SCALING PERMITTED FOR CONSTRUCTION PURPOSES. ALL DIMENSIONS MUST BE CHECKED ON SITE.

Information on this drawing is copyright, all rights reserved. No part of this work may be reproduced or transmitted in any form by any means, either electronically, mechanically, by photocopying, recording or otherwise stored in any retrieval system of any nature, without the express consent of Philip S Ryley & Co.

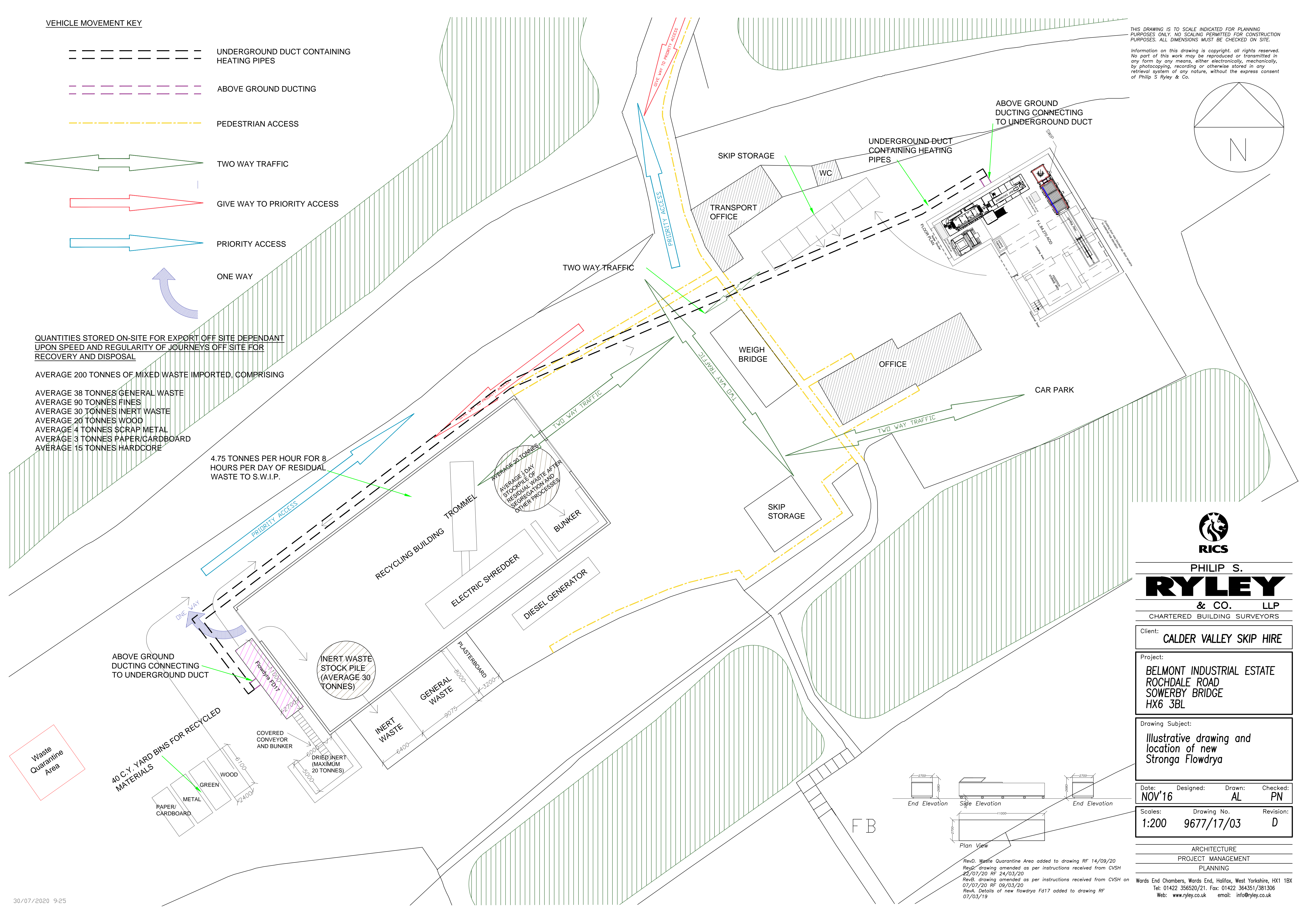
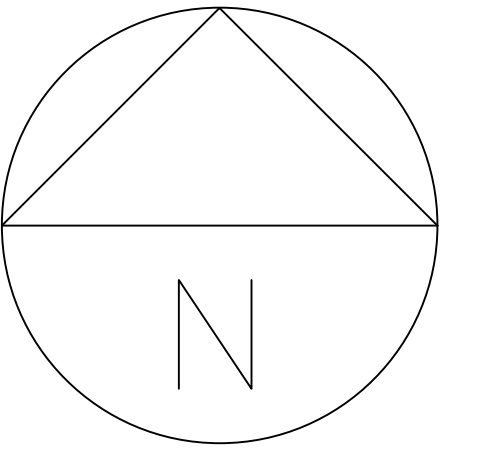

PHILIP S.
RYLEY
& CO. LLP
CHARTERED BUILDING SURVEYORS

Client: **CALDER VALLEY SKIP HIRE**

Project:
**BELMONT INDUSTRIAL ESTATE
ROCHDALE ROAD
SOWERBY BRIDGE
HX6 3BL**

Drawing Subject:
**Illustrative drawing and
location of new
Stronga Flowdrya**

Date: **NOV'16** Designed: **AL** Drawn: **PN** Checked: **PN**

Scales: **1:200** Drawing No. **9677/17/03** Revision: **D**

ARCHITECTURE
PROJECT MANAGEMENT
PLANNING

Wards End Chambers, Wards End, Halifax, West Yorkshire, HX1 1BX
Tel: 01422 356520/21. Fax: 01422 364351/381306
Web: www.ryley.co.uk email: info@ryley.co.uk

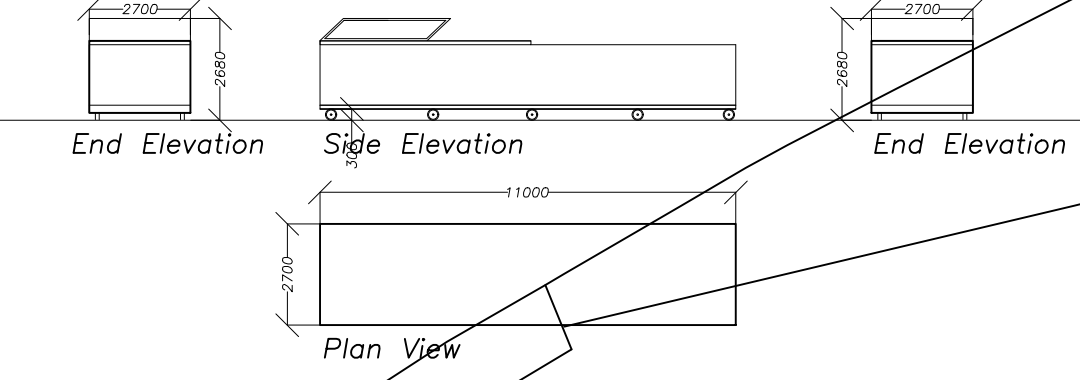

RevD. Waste Quarantine Area added to drawing RF 14/09/20
RevC. drawing amended as per instructions received from CVSH on 22/07/20 RF 24/03/20
RevB. drawing amended as per instructions received from CVSH on 07/07/20 RF 09/03/20
RevA. Details of new flowdrya Fd17 added to drawing RF 07/03/19